

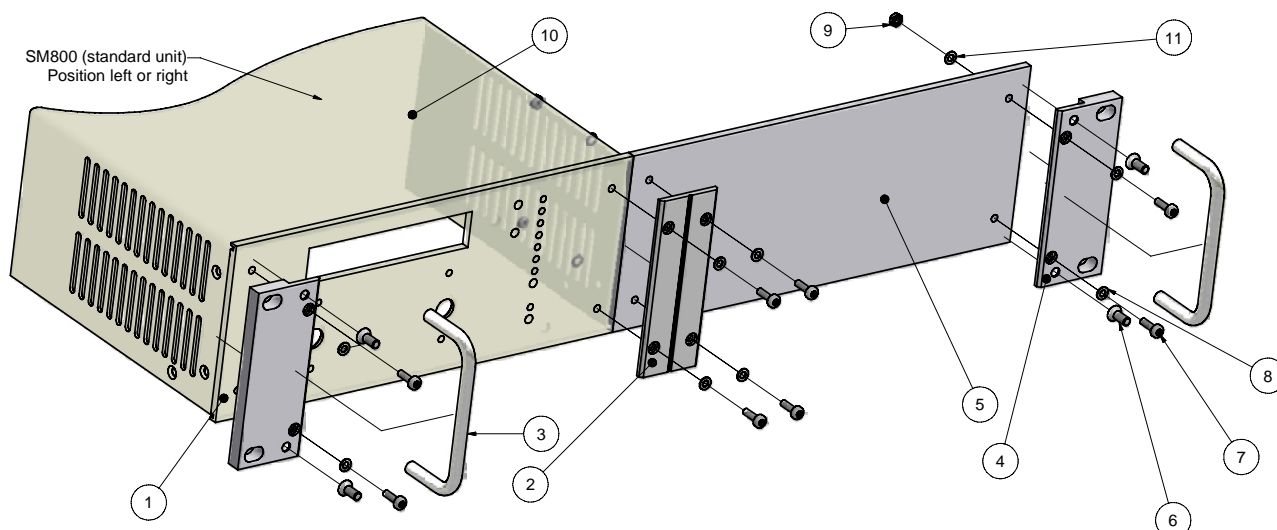

SM800-series 19" RACK ADAPTERS



Single unit **RA19-1SM800**

ITEM	PART NUMBER	TITLE	QTY	ITEM	PART NUMBER	TITLE	QTY
1	DWG2040	front panel	0	7	M3x10 A2 DIN7500C	M3x10 round head torx	8
2	DWG2080	connection plate front (option)	1	8	M3 BN DIN433	M3 BN DIN433	8
3	HANDLE 76	DWG2111	2	9	M3 BN DIN934	nut M3	4
4	DWG2081	connection plate front le.ri.	2	10	DWG2043	cover	0
5	DWG2083	front panel blind	1	11	M3 SZ DIN137A	lockwasher m3x6	4
6	M4x10 A2 DIN7500M	M4x10 countersunk torx	4				

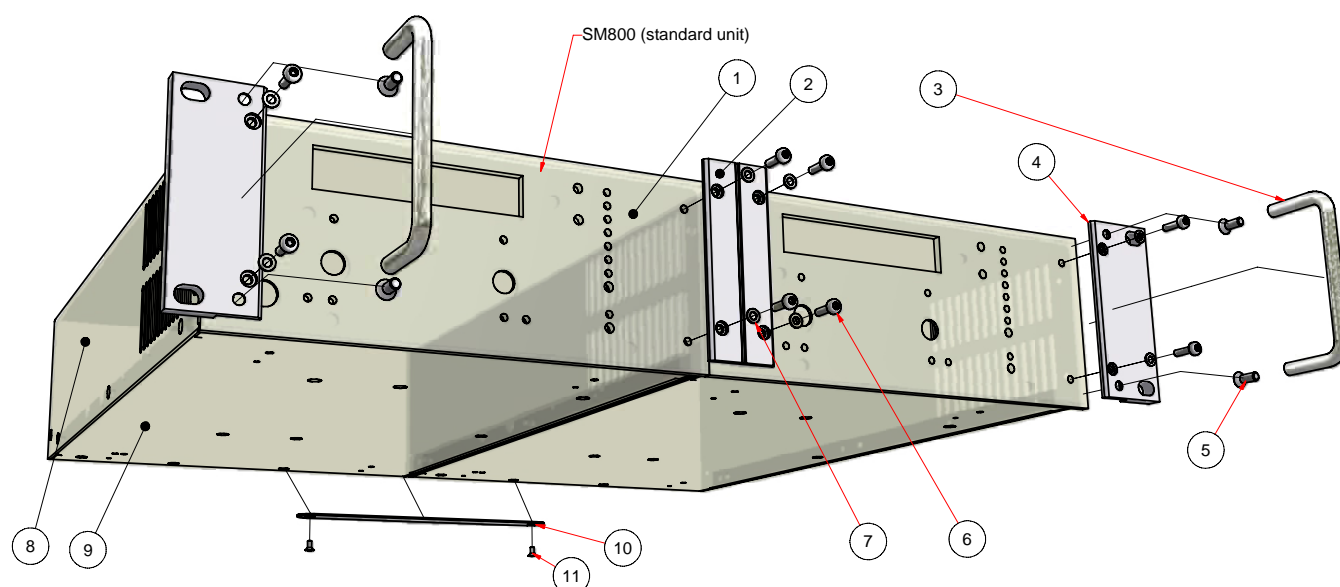

Dual unit **RA19-S2M800**

ITEM	PART NUMBER	TITLE	QTY	ITEM	PART NUMBER	TITLE	QTY
1	DWG2040	front panel	0	7	M3 BN DIN433	M3 BN DIN433	8
2	DWG2080	connection plate front (option)	1	8	DWG2043	cover	0
3	HANDLE 76	DWG2111	2	9	DWG2042	bottomplate	0
4	DWG2081	connection plate front le.ri.	2	10	DWG2087	connection strip	1
5	M4x10 A2 DIN7500M	M4x10 countersunk torx	4	11	M3x6 A2 DIN7500M	M3x6 countersunk	2
6	M3x10 A2 DIN7500C	M3x10 round head torx	8				

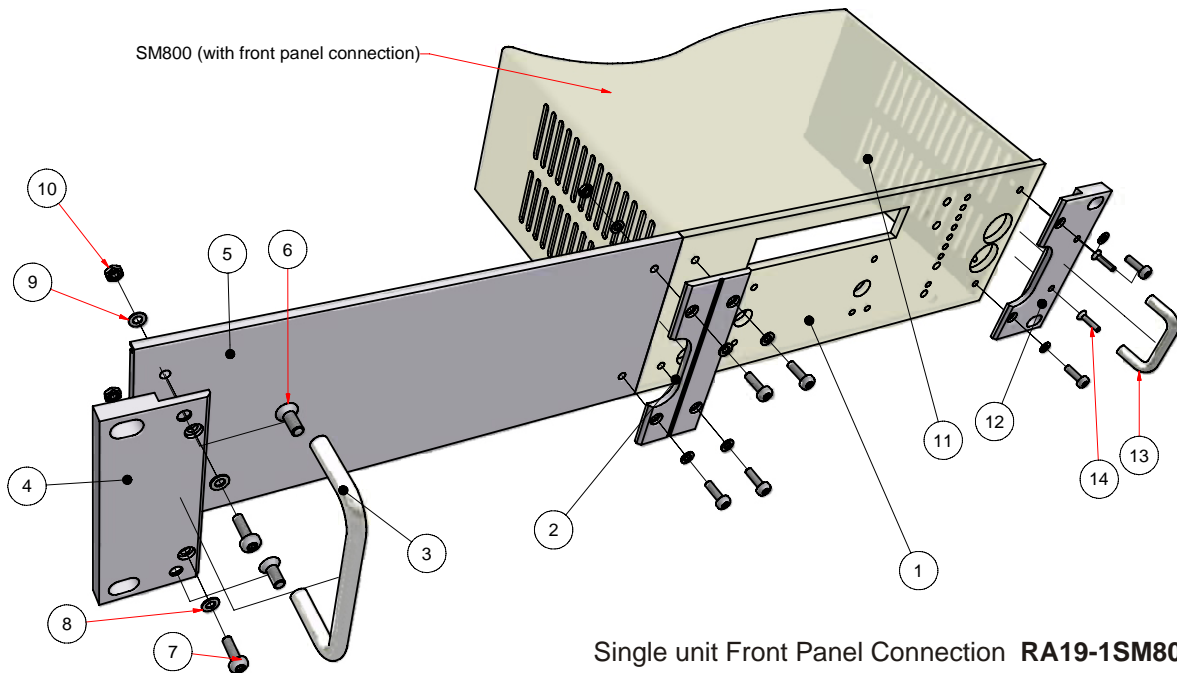

Single unit Front Panel Connection **RA19-1SM800-FPC**

ITEM	PART NUMBER	TITLE	QTY	ITEM	PART NUMBER	TITLE	QTY
1	DWG2089	front panel	0	8	M3 BN DIN433	M3 BN DIN433	8
2	DWG2097	connection plate front FPC option	1	9	M3 SZ DIN137A	lockwasher m3x6	4
3	HANDLE 76	DWG2111	1	10	M3 BN DIN934	nut M3	4
4	DWG2081	connection plate front le.ri.	1	11	DWG2043	cover	0
5	DWG2083	front panel blind	1	12	DWG2082	connection plate front FPC option	1
6	M4x10 A2 DIN7500M	M4x10 countersunk torx	2	13	HANDLE 32	DWG2114	1
7	M3x10 A2 DIN7500C	M3x10 round head torx	8	14	M3x12 A2 DIN7500M	M3x12 countersunk	2

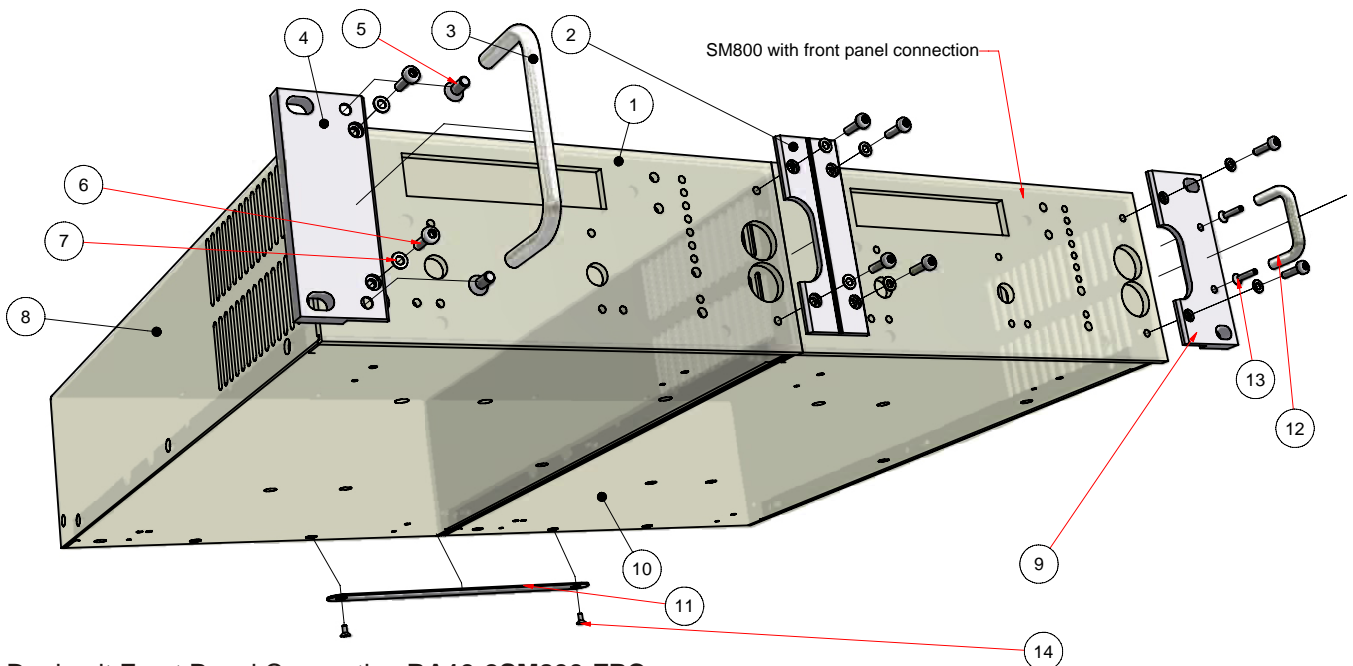

Dual unit Front Panel Connection **RA19-2SM800-FPC**

ITEM	PART NUMBER	TITLE	QTY	ITEM	PART NUMBER	TITLE	QTY
1	DWG2089	front panel	0	8	DWG2043	cover	0
2	DWG2097	connection plate front FPC option	1	9	DWG2082	connection plate front FPC option	1
3	HANDLE 76	DWG2111	1	10	DWG2042	bottomplate	0
4	DWG2081	connection plate front le.ri.	1	11	DWG2087A	connection strip	1
5	M4x10 A2 DIN7500M	M4x10 countersunk torx	2	12	HANDLE 32	DWG2114	1
6	M3x10 A2 DIN7500C	M3x10 round head torx	8	13	M3x12 A2 DIN7500M	M3x12 countersunk	2
7	M3 BN DIN433	M3 BN DIN433	8	14	M3x6 A2 DIN7500M	M3x6 countersunk	2